

Quick Start Guide

Contact Us



Email Us

Technical Support
support@iliferobot.com



Tweet Us

@ILIFEROBOTICS
Mon-Fri: 9:00AM - 18:00PM

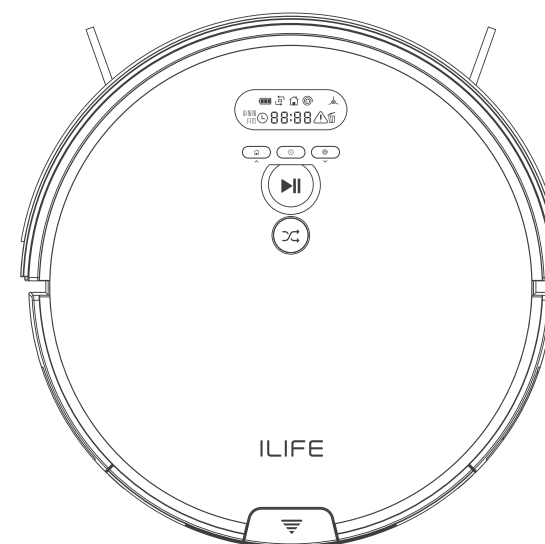

ILIFE Customer Service

Toll-Free Number:

1-800-631-9676 (Toll free for USA & Canada)

Monday-Friday from 9:00 AM -5:00 PM CST

1. Set up the charging dock

- Place the charging dock against a wall and plug the power cord into the outlet. Make sure to leave an uncluttered area about 1 meter at the two sides and 2 meters in the front of the charging dock. Do not place the charging dock near doors, stairs or on the shaggy carpet.

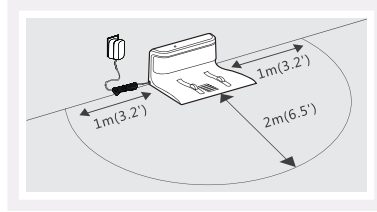

2. Wake up and battery charging for your robot.

- Turn on the main power switch on the side of the robot. The screen will show the battery power level, current time. Then place your robot on the charging dock and will show on the screen. When charging is finished, all lights will turn off.

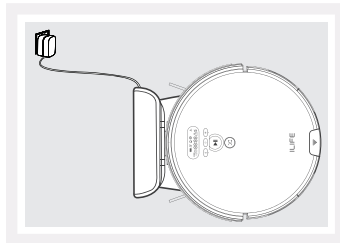
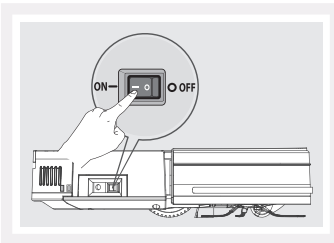

• V8s is ready to clean

- Press to wake up the V8s, then press it again to begin Auto cleaning. The robot will automatically divide your rooms into several areas, then will clean them one by one with Zig zag.
- Press to wake up V8s, then press to start classic cleaning. The robot will clean in random and finish cleaning when the battery low.

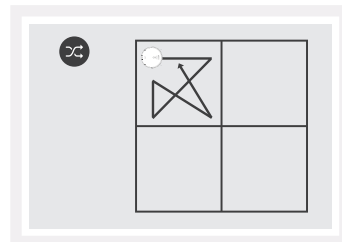
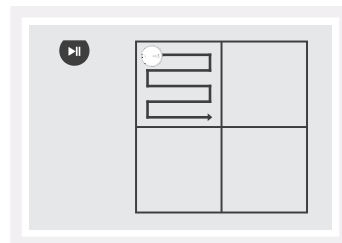

• Intelligent scheduling mode

1 Clock Time Setup

- When the vacuum is turned on, it will beep while pressing the button for 2 seconds, and the Hour part on the display screen will blink, showing that it has entered the state of time setting. Button and are used to adjust the time numbers. Press button to switch between hour, minute, 12/24 hour.
- 12/24 Hour Format Setup: Press button to switch between 12/24 hour format, and the display screen will show ON/OFF respectively.
- When time setting is completed, press button to save the setup.

2 Schedule Cleaning Timer Setup

- Once the schedule is set up successfully, the robot will work on time every day at the certain time. If the power switch at the side of the robot is turned off, the schedule will be lost and need to be reset.
- When the vacuum is turned on, quickly press the button , it will beep and the signs of "" on the display screen will blink, showing that it has entered the state of schedule setting mode. Press button to switch between hours and minutes. Press button and to adjust the time numbers.
 - When the schedule setting is completed, press button to save the setup.

• Important tips with the V8s

- Do not submerge the water tank and dustbin due to some electronic components involved. Only clean with wet mop.
- Regularly empty the dustbin. Take out the dustbin by pressing the release button. Then open and dump out the trash.
- Regularly clean the side brush and nose wheel. Pull out the side brush and nose wheel with your hand and clean them.

